

7437, 7438 Series Reset & Non-Reset Totalizer

The 7437 & 7438 Series are our Veeder-Root standard offering for electro-mechanical counters. This highly reliable family of counters can be actuated by AC or DC voltage pulses as specified. The units are tamper resistant and use thermo-stable materials for long term reliability. Most are 5 digit but 6 and 7 digit models are available.

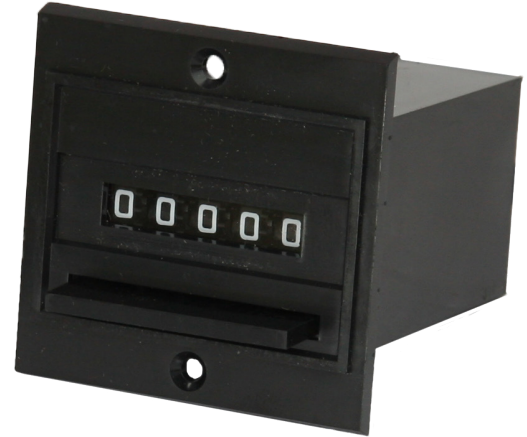

- Broad range of standard AC and DC models
- Base mount and panel mount styles
- High contrast white-on-black figures
- UL recognized; CSA certified
- Tamper resistant construction
- Capable of speeds to 600 counts/minute
- Nonreset and convenient bar-reset models
- Thermo-stable materials used for long term reliability



TIME



COUNT

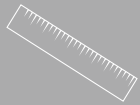

MEASURE

8:43

DISPLAY

ESVR1023-0001 Rev.A



7437, 7438 Series Reset & Non-Reset Totalizer

SPECIFICATIONS

| | |
|------------------------------|--|
| SPEED | 600 cpm |
| MINIMUM COUNT PULSE TIMING | 50 ms on-time and off-time |
| VOLTAGE | Allowable variation is ±10% or 10 volts, whichever is limiting; nonreset counter with 115 VAC coil has allowable variation of 95 to 125 VAC |
| POWER CONSUMPTION | 5 watts on AC, 1.5 watts on DC |
| MAXIMUM ON TIME | DC Models: No limit. Coil can be continuously energized without damage. AC Models: With 50% duty-cycle, 10 minutes maximum |
| NUMBER OF FIGURES | Reset: 5 Nonreset: 5, 6, 7 |
| SIZE OF FIGURES | 0.160" high x 0.110" wide (4.1 mm x 2.8 mm) with 0.023" (0.6 mm) line width on 5 and 6 figure models |
| COLOR OF FIGURES | White on Black |
| OPERATING TEMPERATURE RATING | +32° to +120°F (0° to +49°C). |
| MOUNTING | Base Mount Rear Mount Panel Mount |
| CONNECTIONS | Wire leads, 12", #22 AWG |
| CONSTRUCTION | Wheels, Pinions, Reset mechanism: Acetal resin Frame: Glass filled acetal resin Shafts, Spring: Stainless steel Clapper: Nickel plated SAE 1010 steel Case: Modified polyphenylene oxide |
| WEIGHT | 4 oz. (113.4 g) |

ORDERING INFORMATION

| | |
|------------|--|
| 743785-004 | Base mount, 5 figures, 115 VDC, nonreset, UL/CSA |
| 743785-006 | Base mount, 5 figures, 24 VDC, nonreset, UL/CSA |
| 743785-007 | Base mount, 5 figures, 12 VDC, nonreset, UL/CSA |
| 743795-206 | Panel mount, 5 figures, 24 VDC, nonreset, UL |
| 743796-006 | Base mount, 6 figures, 24 VDC, nonreset, UL |
| 743797-001 | Base mount, 7 figures, 115 VAC, nonreset, UL |

Special Variations Available. Please consult factory.

Obsolete Parts

| | |
|------------|---|
| 743785-001 | Base mount, 5 figures, 115 VAC, nonreset, UL/CSA |
| 743785-002 | Base mount, 5 figures, 230 VAC, nonreset, UL/CSA |
| 743785-003 | Base mount, 5 figures, 24 VAC, nonreset, UL/CSA |
| 743795-101 | Back-of-panel mount, 5 figures, 115 VAC, nonreset, UL |
| 743785-201 | Panel mount, 5 figures, 115 VAC, nonreset, UL/CSA |
| 743796-001 | Base mount, 6 figures, 115 VAC, nonreset, UL |
| 743895-011 | Base mount, 5 figures, 115 VAC, reset, UL |
| 743895-017 | Base mount, 5 figures, 12 VDC, reset, UL |
| 743885-211 | Panel mount, 5 figures, 115 VAC, reset, UL/CSA |
| 743885-216 | Panel mount, 5 figures, 24 VDC, reset, UL/CSA |
| 743895-416 | Rear mount, 5 figures, 24 VDC, reset, UL |

DIMENSIONS

Panel Mount
Depth: 2.377"/60.4mm

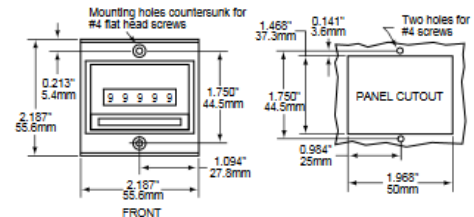

Base Mount
Depth: 2.372"/60.3mm

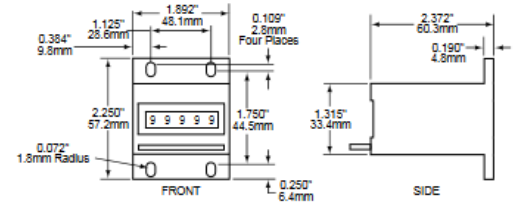

Back of Panel Mount
Depth: 2.377"/60.5mm

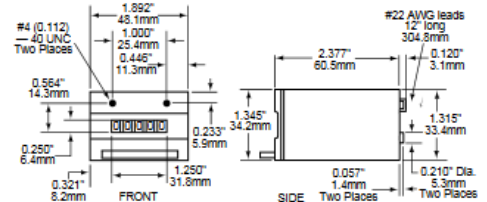

Rear Mount
Depth: 2.377"/60.4mm

